

880/880 Plus Performance™ Series

Programmable Weight Indicator/Controller



880 Plus Universal

880 Plus Panel Mount

Board Information:
Previous green CPU board is 5.0" wide
Current blue CPU board is 5.5" wide

Standard Features

- LED display, 0.56 in (14 mm), six-digit, 14-segment
- RS-232 or RS-485 serial port
- USB device port connects directly to a PC
- USB host port for connecting keyboard or flash drive (v4.00 or newer)
- Ethernet TCP/IP polled or continuous
- AC or DC models
- Built-in DIN-rail clips on controller box (panel mount)
- Display and controller can be separated up to 250 ft (panel mount)
- Hardware slot for one option card
- Operator functions through menu key for audit trail, preset tare, accumulator, time & date and setpoints
- Audit trail tracking for configuration and calibration changes. Password protection for user and configuration changes.
- 20 setpoints with latched batch engine or unlatched outputs
- Four onboard digital I/O channels
- Programmable ticket formats up to 1,000 characters for header text, gross, net, accumulator and setpoints
- Five-point linearization calibration
- Local/remote operation
- Multi-range or multi-interval weighing
- Filter settings for light, medium and heavy noise

Options

- Analog output, relay board and fieldbus connectivity
- AOP (Add On Profile) for EtherNet/IP and more extended configuration files PROFINET, PROFIBUS, DeviceNet and EtherCAT (v4.01 and newer)
- Dual serial output, 24-channel digital input/output (v4.00 and newer)
- Truck in/out program for 100 vehicle IDs
- Adapter plate for converting 310 A and 520 panel mounts
- Panel mount kit for universal enclosure

Specifications

Power:

Line voltages: 100-240 VAC
Frequency: 50-60 Hz
DC voltages: 12-24 VDC
Power consumption: AC: 15 W, DC: 20 W

Excitation Voltage:

10 VDC, 16 x 350 ohm or 32 x 700 ohm load cells

Analog Signal Input Range:

-45 mV to 45 mV

Analog Signal Sensitivity:

0.3 μ V/graduation minimum at 7.5 Hz;
1.0 μ V/graduation recommended

A/D Sample Rate:

7.5 to 960 Hz, software selectable

Resolution:

Internal: 8 million counts/8,000,000 23 bit
Display: 999,999

System Linearity:

\pm 0.01% full scale

Digital I/O:

Four I/O onboard (max), primary keys, pseudo functions, batching functions

Communication Ports:

RS-232 full duplex or RS-485 half duplex;
USB type A connector, USB micro A/B connector
2.0; Ethernet TCP/IP

Status Annunciators:

Gross, net, center of zero, standstill, lb, kg, tare, preset tare, multi-range/interval 1/2/3

Display:

LED, 0.56 in (14 mm), six-digit, 14-segment with decimal or comma

Keys/Buttons:

Membrane panel, tactile feel

Temperature Range:

Certified: 14°F to 104°F (-10°C to 40°C)
Operating: 14°F to 122°F (-10°C to 50°C)

Dimensions (W x H x D):

Panel: 6 in x 4 in x 4.95 in
(152 mm x 102 mm x 126 mm)
Universal: 9.87 in x 9.38 in x 4.33 in
(251 mm x 238 mm x 110 mm)

Weight:

Panel: 2.5 lb (1.2 kg);
Universal: 12 lb (5.4 kg)

Rating/Material:

Panel Mount Display, Stainless Steel
NEMA Type 4X, 12 and IP69
Panel Mount Controller: Aluminum
Universal: stainless steel, IP69

Warranty:

Two-year limited warranty

EMC Immunity:

EN 50082 Part 2 IEC
EN 61000-4-2, 3, 4, 5, 6, 8, 11, 10 V/m

Approvals:

NTEP CC 13-080 Class III/IIIL, 10,000d
Measurement Canada AM-5931C
Class III/IIILD, 10,000d
OIML R76/1992-GB1-04.02 Class III, 10,000d
EU Test Certificate TC8463
UL/cUL Listed (universal)
UL/cUL Recognized (panel mount)
CE Marked

Approvals



880/880 Plus Performance™ Series

Digital Weight Indicator/Controller

Part Number/Price

Part #	Description	Est. Weight	Price
880 Panel Mount AC Powered*			
151674	Display only	2 lb	Consult
177977	115-230 VAC, controller only	4 lb	Consult
177976	115-230 VAC, indicator	4 lb	Consult
177979	115-230 VAC, with analog output	4 lb	Consult
177980	115-230 VAC, with relay board	4 lb	Consult
177982	115-230 VAC, with EtherNet/IP, single port	4 lb	Consult
177983	115-230 VAC, with ProfiNet, single port	4 lb	Consult
177984	115-230 VAC, with Modbus/TCP, single port	4 lb	Consult
177985	115-230 VAC, with Profibus DP	4 lb	Consult
177986	115-230 VAC, with DeviceNet	4 lb	Consult
179155	115-230 VAC, with EtherCAT	4 lb	Consult
880 Panel Mount DC Powered*			
177987	12-24 VDC, indicator	4 lb	Consult
177988	12-24 VDC, controller only	4 lb	Consult
880 Plus Universal AC Powered			
177989 †	115 VAC, indicator	8 lb	Consult
178496 †	115 VAC, with analog output	8 lb	Consult
178499 †	115 VAC, with relay board	8 lb	Consult
179147 †	115 VAC, with EtherNet/IP, single port	8 lb	Consult
179148 †	115 VAC, with Profinet, single port	8 lb	Consult
179149 †	115 VAC, with Modbus/TCP, single port	8 lb	Consult
179150 †	115 VAC, with Profibus	8 lb	Consult
179152 †	115 VAC, with DeviceNet	8 lb	Consult
179154 †	115 VAC, with EtherCAT	8 lb	Consult
177990 ††	115-230 VAC, indicator	8 lb	Consult
178497 ††	115-230 VAC, with analog output	8 lb	Consult
178500 ††	115-230 VAC, with relay board	8 lb	Consult
880 Plus Universal DC Powered			
178495	9-36 VDC, indicator	8 lb	Consult

*Power cord not included

Indicator part numbers contain the single port network card



† US plug (NA) - Type B



†† Euro Plug - Type E

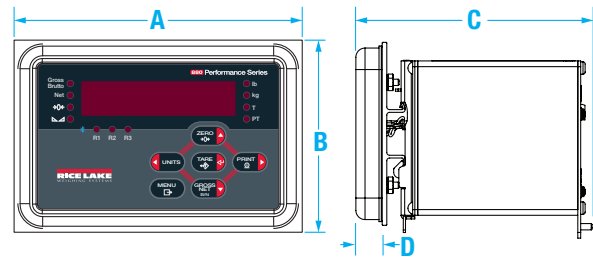

880 Panel Mount Dimensions

A	6.0 in (152 mm)	C	4.95 in (126 mm)
B	4.0 in (102 mm)	D	0.58 in (14 mm) BEZEL DEPTH

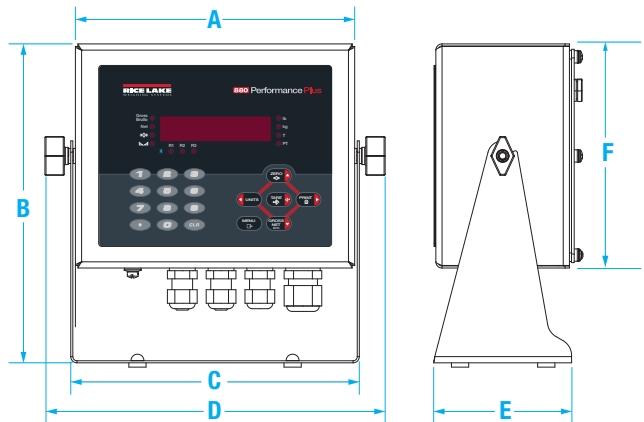

880 Universal Dimensions

A	8.10 in (206 mm)	D	9.87 in (248 mm)
B	9.38 in (235 mm)	E	4.0 in (102 mm)
C	8.37 in (213 mm)	F	6.5 in (165 mm)

Options/Accessories

Part #	Description	Price
Option Cards (5.5 in CPU only)		
179156	Analog output, 0-10 VDC, 0-20 mA, 4-20 mA	Consult
179157	Relay board, four dry contact outputs	Consult
197343**	Digital I/O, 24-channel TTL output	Consult
197347**	Serial ports, dual-channel RS-232/RS-485	Consult
Network Cards		
179158	EtherCAT interface	Consult
179159	EtherNet/IP® interface, single port	Consult
179160	Profinet® interface, single port	Consult
179161	Modbus/TCP/IP interface, single port	Consult
179162	DeviceNet® interface	Consult
179163	Profibus DP interface	Consult
205566	EtherNet/IP interface, dual port	Consult
205567	Profinet interface, dual port	Consult
205568	Modbus TCP/IP interface, dual port	Consult
Hardware		
153660	Metrological sealing kit for panel mount	Consult
158404	Adapter plate for IQ310 and 520 replacement	Consult
101923	Relay box enclosure, does not include relay	Consult
177850	Panel mount kit for universal enclosure	Consult
180835	Universal backplate with RJ-45 receptacle	Consult
197422	Universal backplate with micro USB receptacle	Consult

Options/Accessories

Part #	Description	Price
197724	Clear Protective Overlay for Universal (pack of 5)	Consult
15436	Power cord for panel mount, US plug	Consult
105382	Power cord for panel mount, Euro plug	Consult
Cables		
152434	Cable, USB A to micro A shielded, 2 meters	Consult
156817	Cable, Ethernet RJ45 connectors 1 meter	Consult
156806	Cable, USB A to A, 1 meter	Consult
156809	Cable, USB A to B, 1 meter	Consult
Manuals and Software		
152240	Operators manual	Consult
158387	Technical manual	Consult
Primary Component Parts		
131740	Overlay, panel mount, six-key	Consult
163986	Overlay, universal with numeric keypad	Consult
131598	Display board	Consult
175603*	Power supply, 100-240 VAC	Consult
175604*	Power supply, 12-24 VDC	Consult
175109*	CPU board	Consult

* Design change in 2017 to 5.5 in wide controller, see replacement parts catalog for the 5.0 inch wide boards.

** Requires version 4.0 firmware

To have your option factory installed, please specify when placing your order.